

Banquet

Saturday, July 20

17:05 Final oral presentation ends

17:20 Gather at the bus stop (see map below)

18:00 Arrival at Yushien, Japanese Garden

Enjoy the garden and welcome drink.

18:20 Kagura performance

19:00: Banquet

21:30: Departure from Yushien

22:00: Arrival at Matsue Station

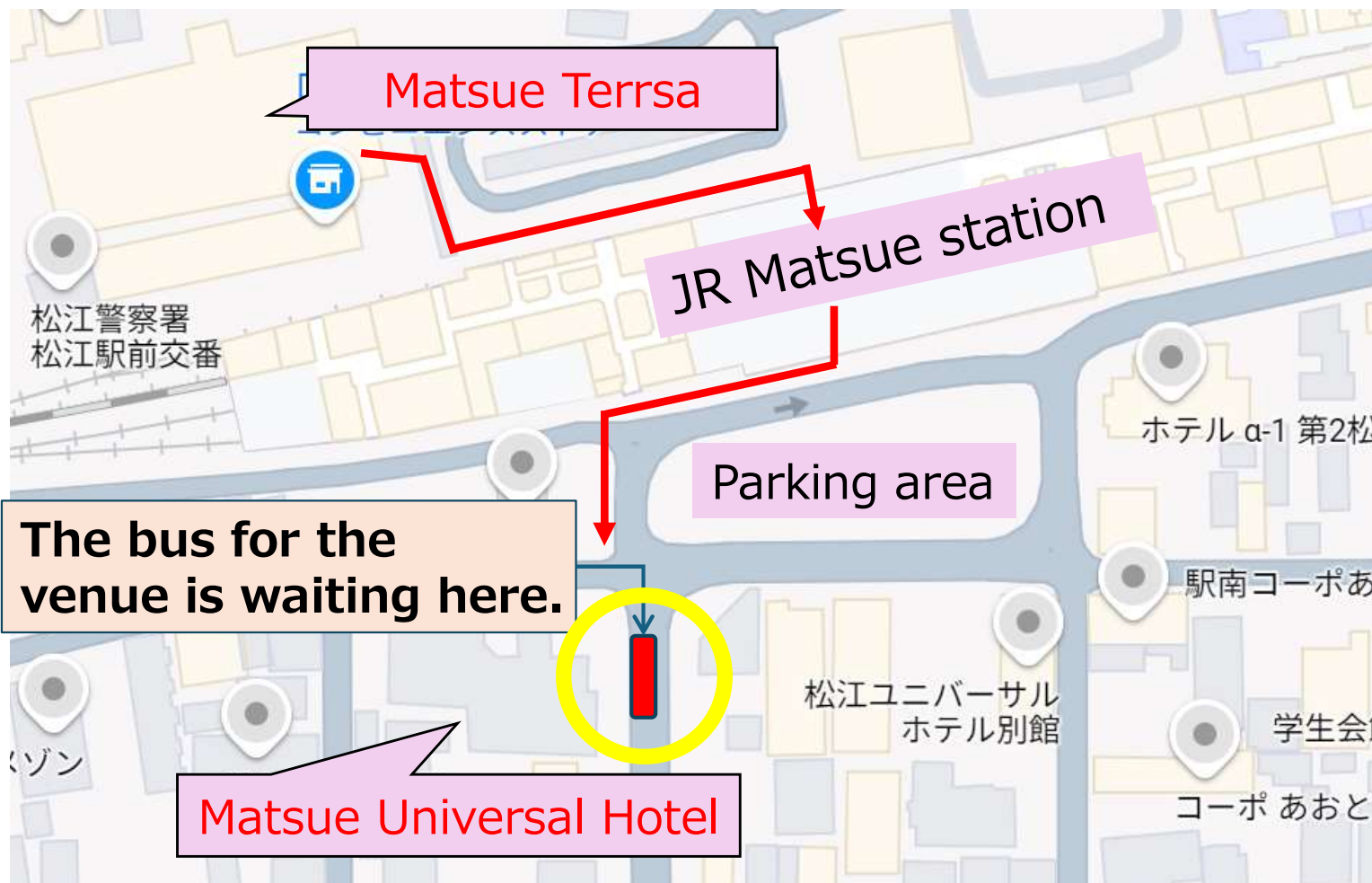

Japanese peony and Korean ginseng village



July 20th, 2024
From 18:00 to 21:30

Yuushien Garden is one of the most splendid Japanese gardens with seasonal flowers, trees, ponds, waterfalls, and paving stones creatively organized over 40,000 beautiful square-meters.



There is a big pond at the center, walking paths are provided around it. When you stroll the paths, you can appreciate the scenery of the season. One of the main attraction is “Japanese Peony house”, in which Japanese peonies are blooming throughout the year!



← Japanese Peony House
-Flower of Shimane prefecture-

Japanese dishes “Washoku” has been recently recorded on the list of the World’s Intangible Cultural Heritage.

You can expect fine dishes that uses local ingredients, such as Daikonshima Ginseng.



Special Program –KAGURA DANCES–

Iwami Kagura is a traditional form of folk theater from the Iwami region in Shimane Prefecture. It is a vibrant and energetic performance that combines dance, music, and storytelling to depict various myths, legends, and historical tales.

Today's program
–Iwami Kagura's **Yamata-no-Orochi** –
is one of the most attractive numbers.

This captivating performance tells the ancient myth of the fearsome eight-headed, eight-tailed serpent, Yamata-no-Orochi.



Story of Yamata-no-Orochi

One day the deity Susanoo came down to earth.

He saw an old couple and their daughter grieving. They told him that seven of their daughters had already become victims to an eight-headed Yamata-no-orochi, and it was coming to attack their last (8th) daughter named Kushinada-hime that night.

Susanoo decided to overcome the serpent to save their daughter, because she was very beautiful. He asked the old couple, if he slayed Yamata-no-Orochi, he will take their daughter to his wife. And they agreed.

Susanoo told the old folks to prepare eight tubs of strong sake and put them in the entrances of the eight- opening fence.

In the night Yamata-no-Orochi came to the fence...

The rest is for you to see and enjoy.

Excursion

Monday, July 22

08:30 Gather at the bus stop (same place as the banquet)

09:30 Arrival at Izumo Taisha Shrine

Explore the grounds of the shrine.

10:30 Gather at the bus stop (refer to the map below).

Then, move to Tamatsukuri Onsen.

*Departure and arrival locations are different.



11:30 Arrival at Kasuien Minami.

Lunch featuring kaiseki cuisine.

Then, hot springs and exploring the surroundings.

15:00 Gather in the waiting room at the 1st floor.

Board the bus.

15:30 Arrival at Matsue Station and disband

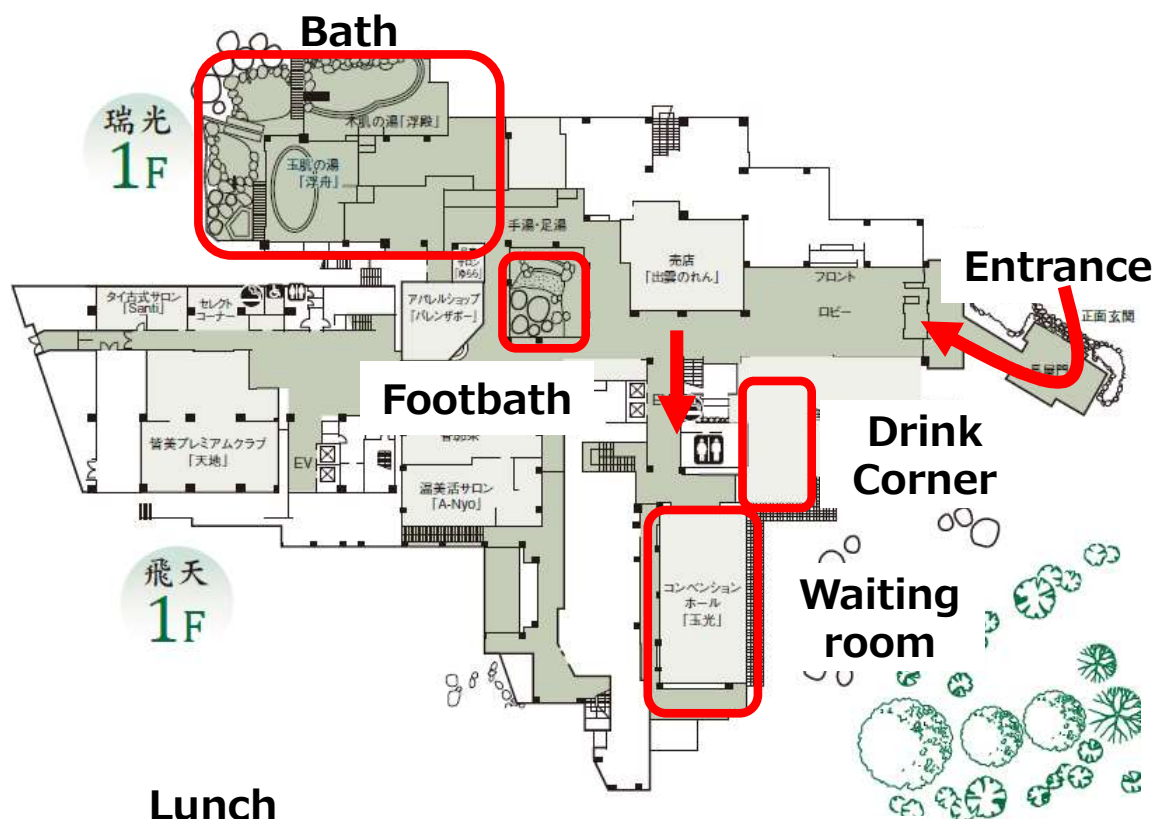

Lunch

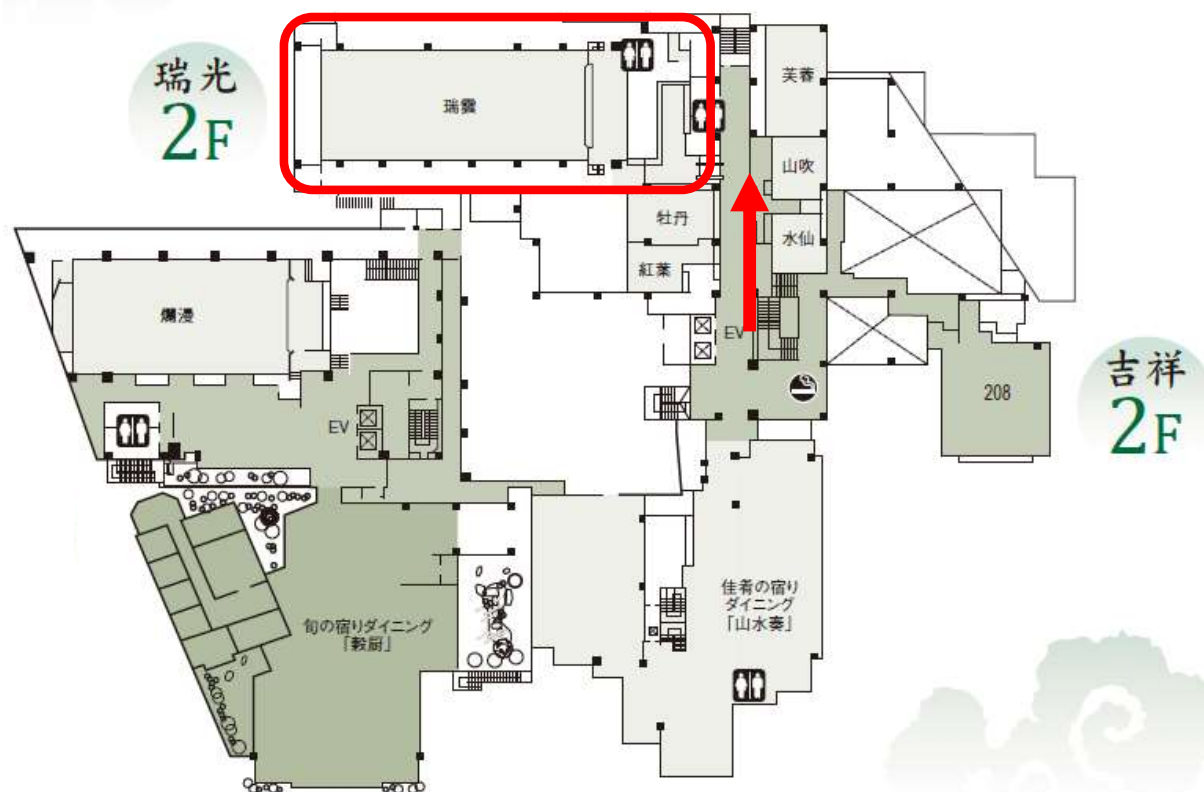

Izumo Taisha Shrine

Izumo Taisha is one of Japan's oldest and most important shrines, built in 1744 and designated as a national treasure.

The enshrined deity, Okuninushi-no-Kami, is associated with romance, marriage, relationships, medicine, and agriculture.

Unlike the typical Shinto prayer ritual of 2 bows, 2 claps, and 1 bow, Izumo Taisha uses **2 bows, 4 claps, and 1 bow**.

Historically, Izumo Taisha was believed to be Japan's tallest building at 96 meters. In the Middle Ages, it was 46 meters, and today it stands at 24 meters, still impressing visitors with its majestic appearance.





Request for Using the Hot Springs

- There are a limited number of places where you wash your body. It will be very crowded if everyone enters the hot springs immediately after lunch.

During peak times, we kindly ask for your cooperation in waiting by exploring the hot spring town, purchasing souvenirs, or using the foot baths.

- There are lockers with keys in the changing room to store your valuables. When using the hot springs, please store your valuables either in the lockers or in the waiting room.
- In the waiting room, we have provided **bath towels and face towels** for loan. Please use one of each per person.